

WELCOME HOME



Hickory Glen is situated on the beautiful rolling terrain of a former horse ranch. Offering a thoughtfully placed homesite in a majestic setting, Hickory Glen is Adams Township's premiere single-family home community.



HICKORY GLEN

M A R S P E N N S Y L V A N I A

Contact Gary Sarti today at
412-525-9409

GSARTI@WEAVERHOMES.COM

W E L C O M E H O M E

Weaver Homes was founded in 1986 by Bill and Bonnie Weaver. Since our inception, Weaver Homes has grown into one of the Pittsburgh area's largest residential builders and developers. As a family owned and operated business, our team is there every step of the way during the construction process to make sure your dream home is everything you've imagined and more.



● AVAILABLE ● RESERVED ● SOLD ● MODEL

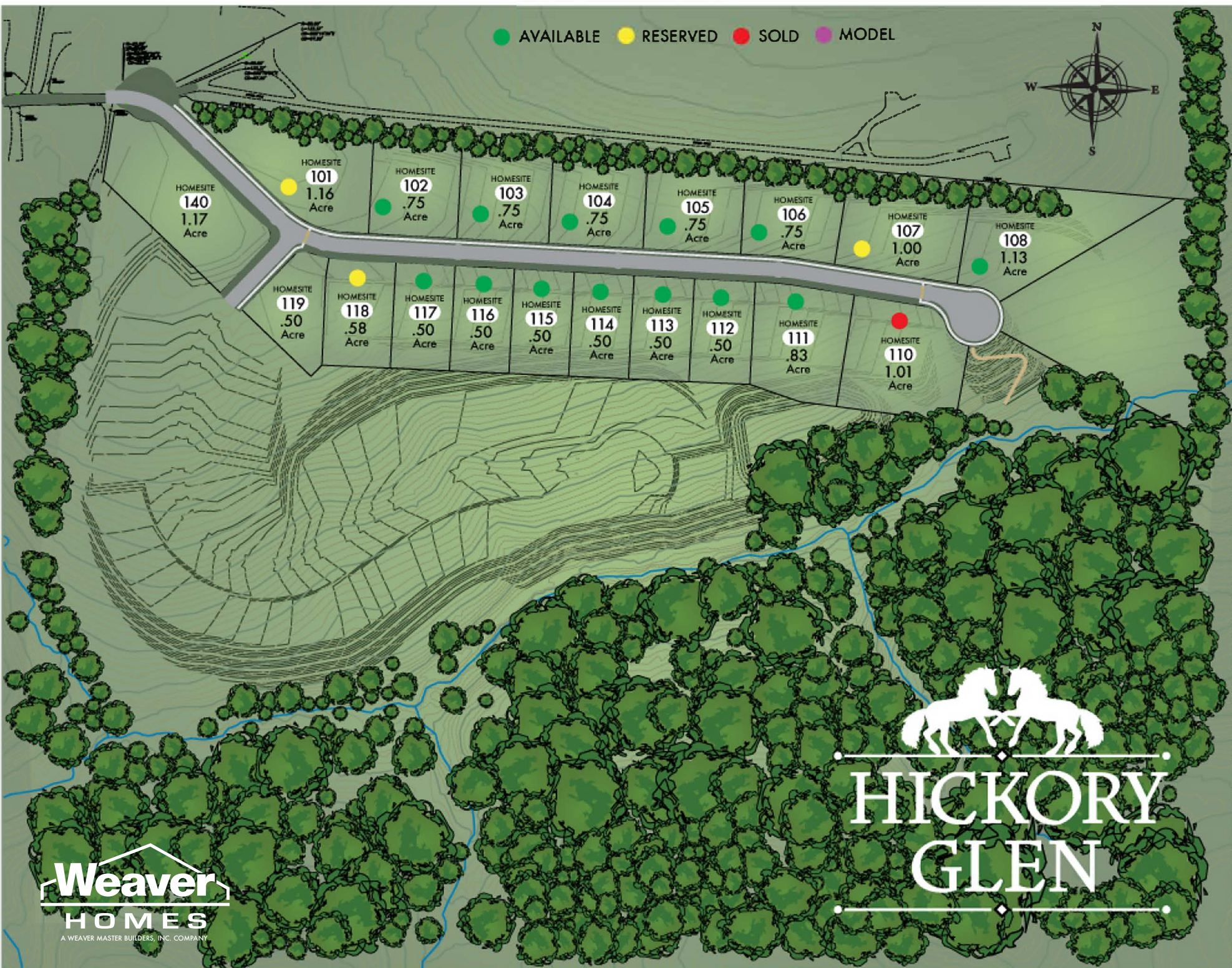

HICKORY GLEN

Weaver
HOMES
A WEAVER MASTER BUILDERS, INC. COMPANY

Included Features

HICKORY GLEN SINGLE-FAMILY HOMES

Concrete Driveways

Poured concrete pad outside all walkout doors

Brick to Grade with basement

Tuff-N-Dri Lifetime Foundation
Waterproof System

Therma Tru 6 panel steel front door

Pella double hung windows
with casing around windows

Wayne Dalton Steel insulated
garage door with windows

2 Outside faucet connections

Garage floor drain

LiftMaster 1/2 HP Garage Door opener
with keypad and two remotes

75 Gallon hot water tank

High efficiency gas furnace

Safety protect wall outlets throughout

Programmable thermostat

Laundry tub per print

Ice maker water line in kitchen

9' ceilings first floor

Brushed Nickel MOEN Plumbing/
Progress Lighting fixture package (Level 2)

Recess lights in kitchen and
Pendant Lights over the island

Merillat Spring Valley Maple cabinets
in choice of stain (Level 2)

Soft close doors and drawers in kitchen and baths

Solid wood drawers w/ dovetail joints

Roll out shelves in base cabinets

42" Wall cabinets in kitchen

Granite kitchen tops with
stainless double bowl sink

Stainless Steel Whirlpool appliance package

1/3 horsepower Badger garbage disposal
with push button counter start

Kitchen Island per plan

SHAW Hardwood flooring,
foyer, powder room, kitchen

SHAW Ceramic floor in baths & laundry

SHAW Carpet with 6lb 1/2" padding

White quartz vanity tops

Gentleman height vanities in master bath

Choice of interior door styles

Lever door handles throughout

Oak handrail with painted spindles,
open treads and oak stairs on main staircase

3 1/4" Colonial Window Casing

4 1/2" Baseboard Trim

Crown moulding on entire first floor,
chair rail in dining room

Custom closet wire wrapped shelving

Painted garages with cased windows

30 Year Architectural Tamko Shingle

Ceiling Fan Rough-Ins all bedrooms

Starter lawn and landscape beds installed



AVAILABLE HOMES AT HICKORY GLEN

Our open concept floorplans, including first floor master options, offer plenty of square footage that can be personalized to make each of our homes truly unique to their owners.



Easton Starting at \$550,000
3-4 Beds | 2 Stories | 2.5 Baths | 2 Car Garage
2,228 Sq. Ft. First Floor Master BR



Lancaster Starting at \$530,000
4 Beds | 2 Stories | 2.5 Baths | 2 Car Garage
2,077 Sq. Ft.



Fulton Starting at \$570,000
4 Beds | 2 Stories | 2.5 Baths | 2 Car Garage
2,250 Sq. Ft. First Floor Master BR



Clifton Starting at \$550,000
4 Beds | 2 Stories | 2.5 Baths | 2 Car Garage
2,331 Sq. Ft.



Barclay Starting at \$560,000
4 Beds | 2 Stories | 2.5 Baths | 2 Car Garage
2,400 Sq. Ft.



Harrison Starting at \$565,000
4 Beds | 2 Stories | 2.5 Baths | 2 Car Garage
2,413 Sq. Ft.



Millcreek Starting at \$575,000
4 Beds | 2 Stories | 2.5 Baths | 2 Car Garage
2,648 Sq. Ft.



Heatherfield Starting at \$579,000
4 Beds | 2 Stories | 2.5 Baths | 2 Car Garage
2,660 Sq. Ft.



Townsend Starting at \$615,000
4 Beds | 2 Stories | 2.5 Baths | 2 Car Garage
2,725 Sq. Ft.
First Floor Master BR



Ashton Starting at \$589,000
4 Beds | 2 Stories | 2.5 Baths | 2 Car Garage
2,820 Sq. Ft.



Summerfield Starting at \$630,000
5 Beds | 2 Stories | 3.5 Baths | 3 Car Garage
3,156 Sq. Ft.



Grayson Starting at \$720,000
4-6 Beds | 2 Stories | 3.5 Baths | 3 Car Garage
3,803 Sq. Ft.



HICKORY GLEN

Easton	2,228 sqft	Starting at	\$550,000
Lancaster	2,077 sqft	Starting at	\$530,000
Fulton	2,250 sqft	Starting at	\$570,000
Clifton	2,331 sqft	Starting at	\$550,000
Barclay	2,400 sqft	Starting at	\$560,000
Harrison	2,413 sqft	Starting at	\$565,000
Millcreek	2,648 sqft	Starting at	\$575,000
Heatherfield	2,660 sqft	Starting at	\$579,000
Townsend	2,725 sqft	Starting at	\$615,000
Ashton	2,820 sqft	Starting at	\$589,000
Summerfield	3,156 sqft	Starting at	\$630,000
Grayson	3,803 sqft	Starting at	\$720,000

Contact Gary Sarti today at 412-525-9409 | GSARTI@WEAVERHOMES.COM