



# RICHMOND PARK

**NEAL** COMMUNITIES

2015 Professional Builder  
**BUILDER OF THE YEAR**



SOUTHWEST FLORIDA'S MOST EXPERIENCED HOME BUILDER FOR OVER 40 YEARS





# RICHMOND PARK



In a vibrant corner of north Naples close to dining, shopping and recreation, this island-themed carriage-home community features a large lake, clubhouse, sparkling pool and spacious sundeck. Luxurious two- and three-bedroom floor plans all come with either a one- or two-car garage. With only 104 carriage homes at Richmond Park, you should choose yours right away!



**NEAL** COMMUNITIES



SOUTHWEST FLORIDA'S MOST EXPERIENCED HOME BUILDER FOR OVER 40 YEARS





**NO CDD!  
AFFORD MORE  
& PAY LESS!**



**BUILDING.  
HOME.  
LIFE beyond  
compare.**



**NO  
CDD  
FEES!**



# **RICHMOND PARK**

## **BUYERS SAVE THOUSANDS WHEN THEY PURCHASE A HOME AT RICHMOND PARK**

For over 40 years, Neal Communities has built thousands of high-value homes in over 80 communities throughout Southwest Florida. The financial stability that comes with that kind of track record benefits our customers in many ways.

As a resident of Richmond Park by Neal Communities, you pay no CDD fees. Community Development District (CDD) fees are often necessary to help pay for a community's infrastructure. This fee appears on your annual tax bill and can range from \$600 to \$3,000 per home, every year, for an average of 20-30 years. Over the life of this bond, homeowners in CDD communities can pay as much as \$30,000 to \$60,000. With no CDD fees to pay, residents of Richmond Park enjoy significant savings!

Neal Communities understands the importance of owning a quality home in a beautiful neighborhood, while having money left over to enjoy your Southwest Florida lifestyle. At Richmond Park, you'll get everything you expect and more, from Builder of The Year, Neal Communities.

**NEAL COMMUNITIES**



**SOUTHWEST FLORIDA'S MOST EXPERIENCED HOME BUILDER FOR OVER 40 YEARS**



## COMMUNITY FEATURES

- Convenient to Naples' world-class shopping and dining at The Mercato, Tin City, Fifth Avenue South, Third Street South, Waterside Shops; and attractions including Artis-Naples, The Naples Philharmonic, The Naples Players Sugden Community Theatre and world-class beaches
- A gated, 8-plex carriage home community
- Amenities include a community clubhouse, pool and sundeck
- Beautifully landscaped entry and streetscape
- Beautiful lake and preserve views
- No CDD fees

## AWARD-WINNING DESIGN FEATURES

- Architectural details including custom-designed Coastal elevation
- Designer-selected exterior building color palettes
- Neal Design Gallery offers the opportunity to personalize your home
- The proven quality, service and integrity of Neal Communities

## LUXURY FEATURES

- Textured finish on walls and ceiling
- Classic colonial moldings
- Solid-surface window sills
- Stylish lever door hardware
- Deadbolt on front entry door
- Classique two-panel, wood-grain interior doors
- Spacious closets with ventilated shelving
- Plush, stain-resistant wall-to-wall carpeting in designer colors (per plan)
- 18" x 18" ceramic tile floors in kitchen, foyer, laundry and baths
- Spraycrete® top-coat finish on screened lanai
- Paver entry, walk and drive
- Decorative coach lights

## QUALITY KITCHEN FEATURES

- General Electric® appliance package in white or black per plan:
  - 5-year General Electric Factory Warranty
  - Over-the-range microwave oven
  - Dishwasher
  - Side-by-side refrigerator with ice and water dispenser
  - 1/2-HP disposal
  - Washer and dryer

- Recessed-panel wood veneer cabinets with stylish hardware
- 36" upper cabinets
- 3cm granite countertops
- Stainless undermount double sink
- Chrome single-lever faucet with side sprayer
- Spacious pantry for additional storage per plan

## LUXURY BATH FEATURES

- Cultured marble top with integral bowl in master bath and guest bath
- Ceramic tile walls and framed glass shower enclosure in master bath
- Recessed-panel wood veneer cabinets
- Elongated private water closet in master bath
- Full-width vanity mirrors
- Chrome Moen® faucets
- Water-resistant tile backer in all wet areas
- Designer vanity lights
- White tub in guest bath
- Mirrored medicine cabinets
- Vented exhaust fans in all baths

## QUALITY CONSTRUCTION FEATURES

- Durable, reinforced concrete block construction
- Professionally engineered structural components
- Raised-panel overhead garage door
- Concrete tile roof

## ENERGY SAVING FEATURES

- Low-E impact-resistant windows and sliding glass doors
- R-30 ceiling insulation
- Premium fiberglass insulated entry door with weather stripping
- High-efficiency air-conditioning system with digital programmable thermostat
- All air-conditioning ductwork 3rd-party tested

## QUALITY ELECTRIC FEATURES

- Decora® light switches throughout
- Recessed lighting package in select areas
- Hardwired combination smoke and CO2 detectors with battery backup
- Prewired for ceiling fans (per plan)
- Garage door operator with remote control
- Cat-5 telephone and RG6 cable outlets
- GFI exterior outlet (per plan)



**RICHMOND  
PARK**

2311 Sawyers Hill Rd | Naples, FL 34120

**239.558.0598 | [RichmondParkNaples.com](http://RichmondParkNaples.com)**

**NEAL COMMUNITIES**



SOUTHWEST FLORIDA'S MOST EXPERIENCED HOME BUILDER FOR OVER 40 YEARS



Neal Communities reserves the right to make changes to this information at any time without notice. This document supersedes previously published Included Features. See Sales Representative for complete details on Included Features.



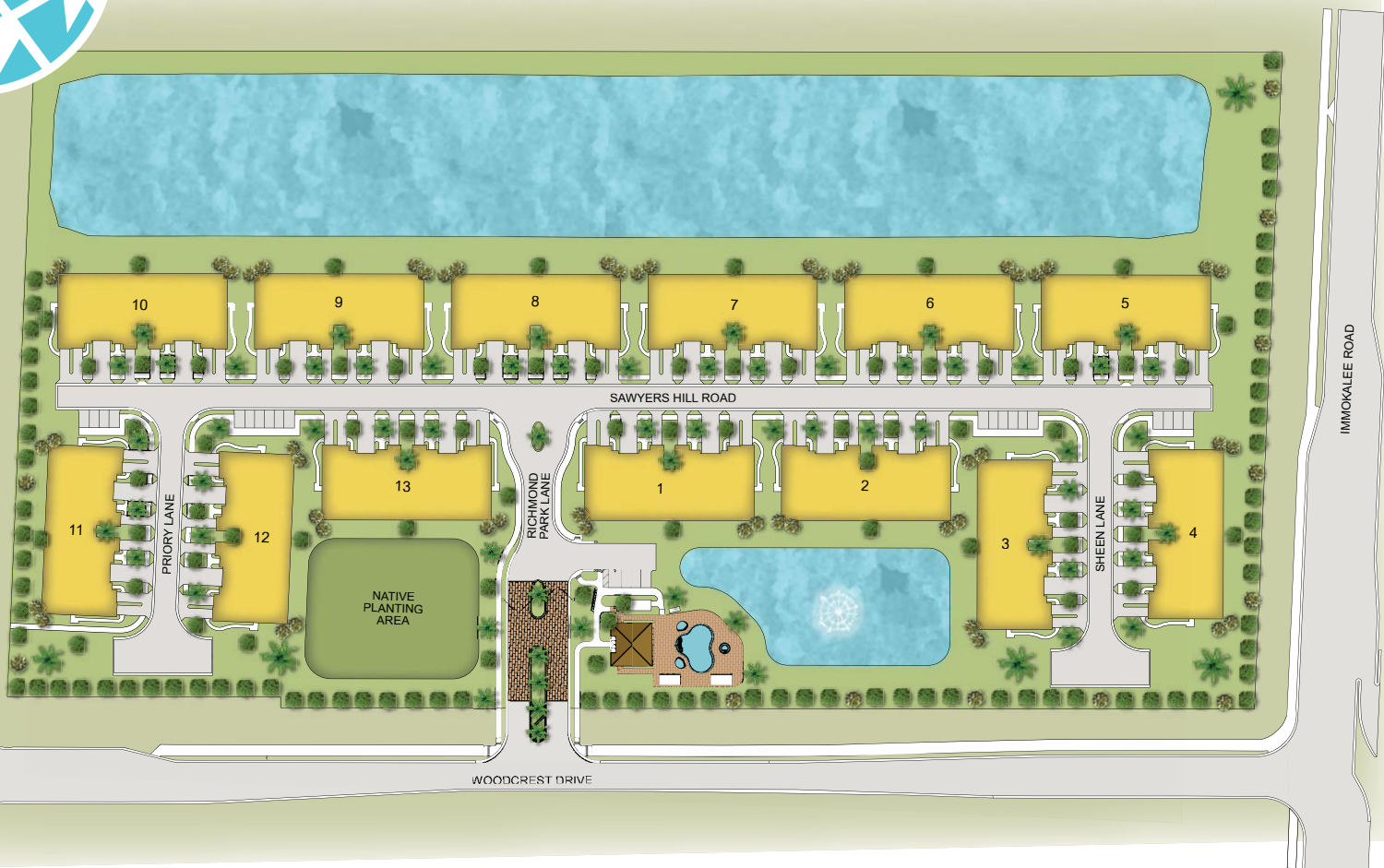

# RICHMOND PARK

2311 Sawyers Hill Rd | Naples, FL 34120

**239.558.0598 | [RichmondParkNaples.com](http://RichmondParkNaples.com)**

**NEAL COMMUNITIES**





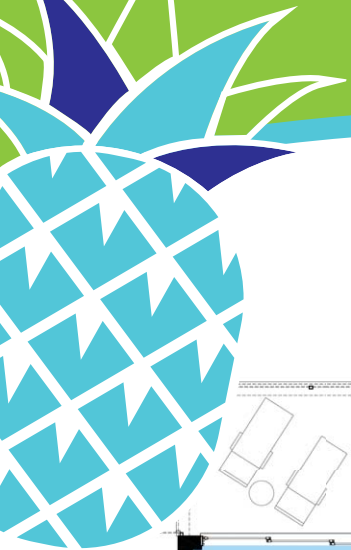

## KESWICK

Total Living Area .....	<b>1,339</b>
Lanai .....	207
Garage .....	240
Covered Entry .....	26
<hr/>	
Total Area .....	<b>1,812</b>

## KENDAL

Total Living Area .....	<b>1,467</b>
Lanai .....	232
Garage .....	236
Covered Entry .....	58
<hr/>	
Total Area .....	<b>1,993</b>

## Windemere

## Whitehaven



### WINDEMERE

Total Living Area .....	<b>1,660</b>
Lanai .....	207
Garage .....	231
Covered Entry .....	26
<b>Total Area .....</b>	<b>2,124</b>

### WHITEHAVEN

Total Living Area .....	<b>1,725</b>
Lanai .....	232
Garage .....	372
Covered Entry .....	58
<b>Total Area .....</b>	<b>2,387</b>