

# YOUR *Home*

## Standard Features

### Exterior Design

- **High-quality American-made Clay Brick Construction with Traditional Architectural Detailing**
- Professionally Landscaped Yards with Upgraded Shrub Package
- **Full Sod and Trees to Complement Landscape Plan**
- **Full Yard Sprinkler System**
- Multidimensional Layered Fiberglass-asphalt Shingles with Minimum 30-year Limited Warranty
- **Large, Covered Patio**
- Weatherproof Electric Outlets in Front and Rear
- Exterior Hose Bibs in Front and Rear
- Cast Stone Keystones and Address Block (per elevation)
- **8' Solid Alder Wood Front Door with Decorative Satin Nickel Handle Set**
- Fiber-Cement Exterior Siding, Soffit and Fascia for a Low-maintenance Exterior
- Decorative Black Coach Lamps
- Low-maintenance Metal Garage Door or Designer Wood-trimmed Metal Garage Door (per elevation)
- Full Front Gutters
- Fully Sheetrocked and Painted Garage
- Full-lite Glass Rear Door

### Interior Design

- Professional Interior Design Consultant to Assist in Color and Option Selection Process
- Hand-laid 12" Ceramic Tile in Entry, Kitchen and Breakfast Area, All Baths and Utility
- **Elegant Rounded Sheetrock Corners in All Areas Except Windows**
- 220V Dryer Outlet
- **8' Classic Raised Panel Interior Doors (First Floor) with Satin Nickel Hardware and Lever Handles**
- **Fireplace with Custom Cast Stone Surround and Mantle**
- Multi-speed Ceiling Fan with Light Kit in Family Room, Master Bedroom, Gameroom and Study (per plan)
- Separate Full-sized Utility Room with Built-in Shelving
- Pre-wired (RG-6) for TV in Master Bedroom, Family Room and Gameroom (per plan)
- **5 1/4" Baseboards and 3 1/2" Casing Throughout**
- Lighted Attic Access with Hide-away Pull-down Stairs
- Wood Cabinets in Master and Secondary Baths to Match Kitchen Cabinets
- Elongated Commodes in All Baths
- **Granite Vanity Countertops with Undermount Sinks in Full Baths**
- Pedestal Sink with **Moen**® Chrome Faucet and Framed Mirror in Powder Room
- Sterling® by Kohler® Composite Bath Tubs with 12" Tile Surround in Secondary Baths
- Satin Nickel Hardware and Lighting Fixtures
- Chrome Bath Hardware

### Gourmet Lifestyle Kitchen

- **Granite Countertops** with 12" Ceramic Tile Backsplash
- **Castle-style Wood Cabinetry**
- Spacious Sun-lit Breakfast Area (per plan)
- **Whirlpool® Stainless Steel** Appliances Including:
  - 30" Cooktop with Vent Hood
  - Built-in Oven and Microwave in Separate Cabinet
  - **Energy Star**® Qualified Multi-cycle Dishwasher
- 8" Deep Stainless Steel **50/50 Undermount** Sink with **Moen**® **Camerist** Single-handle Faucet and Vegetable Sprayer
- Garbage Disposal
- Recessed Can Lighting

### Elegant Master Suite

- **Granite Vanity Tops with Dual Undermount Sinks**
- Luxurious Garden Tub with Moen® Boardwalk Chrome Faucets and Ceramic Tile Skirt and Backsplash
- Separate Free-standing Shower Enclosure with Tile Surround and Acrylic Pan
- 42" Height Framed Mirrors in Master Bath
- Raised Master Bath Vanity
- Large Walk-in Closet
- Medicine Cabinet (master bathroom only)
- Quiet Sitting Areas with Creative Window Design (per plan)

### Safety and Energy Features

- **Radiant Barrier Roof Decking**
- **Energy-efficient Vinyl Windows with Low E3 Glazing**
- **50-Gallon Energy-efficient Water Heater**
- **R-38 Insulation in Attic (R-22 in sloped ceilings)**
- R-13 Insulation in All Exterior Walls (excluding garage)
- Programmable Thermostat
- **Lennox® 14-SEER** Cooling/Heating System (dual zone in two stories) with **R-6 Ductwork**
- Security System – Intrusion Alarm on Exterior Doors with Attic Siren and One Keypad
- Smoke Detectors with Battery Backup for Continuous Operation
- Poly Sealant on Exterior Walls, Windows, Doors and Base Plates
- Attic Air Flow Ventilation with Soffit and Roof Venting
- Water-conserving Commodes
- All Exterior Doors Professionally Weather-stripped
- Pre-wired for Garage Door Opener

### Quality Features

- 10-Year Limited Warranty
- Professionally Engineered Post-tension Foundations
- **On-site Framing (not pre-fab)**
- Professionally Engineered Floor Joist System



# YOUR *Neighborhood*

## Life Katy Trails

A neighborhood park is the centerpiece for the picturesque community of Katy Trails. Enjoy the beauty of living in the sought-after city of Katy, with easy access to fine dining, shopping and entertainment.

## Amenities

- Flexible Floor Plans
- Katy ISD
- Convenient Location
- Easy access to Grand Parkway (99), Interstate 10 and Highway 90
- Shopping, Dining and Entertainment Options Nearby

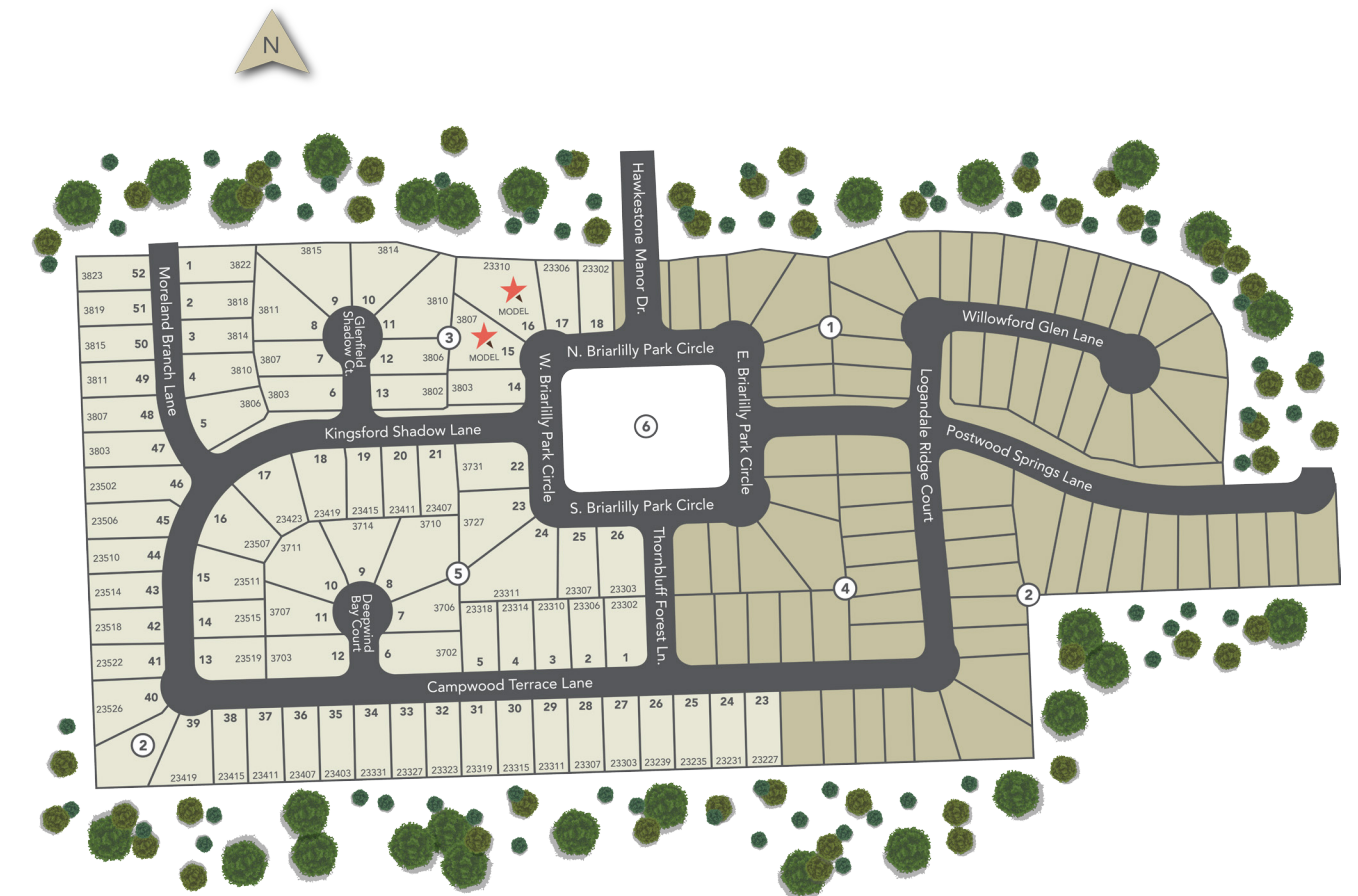

# YOUR *Community*

## Community Information

### Homeowner's Association

HOA: \$500 Annually  
 Cap Fee: \$250  
 Transfer Fee: \$185

### School District

**Catherine Bethke Elementary**  
 4535 E Ventana Pkwy  
 (281) 234-4200

**Stockdick Junior High**  
 4777 Peek Rd  
 (281) 234-2700

**Patricia E. Paetow High School**  
 23111 Stockdick School Rd  
 (281) 234-4906

### City Taxes

TOTAL: 3.6517  
 Per \$100  
 Assessed Value

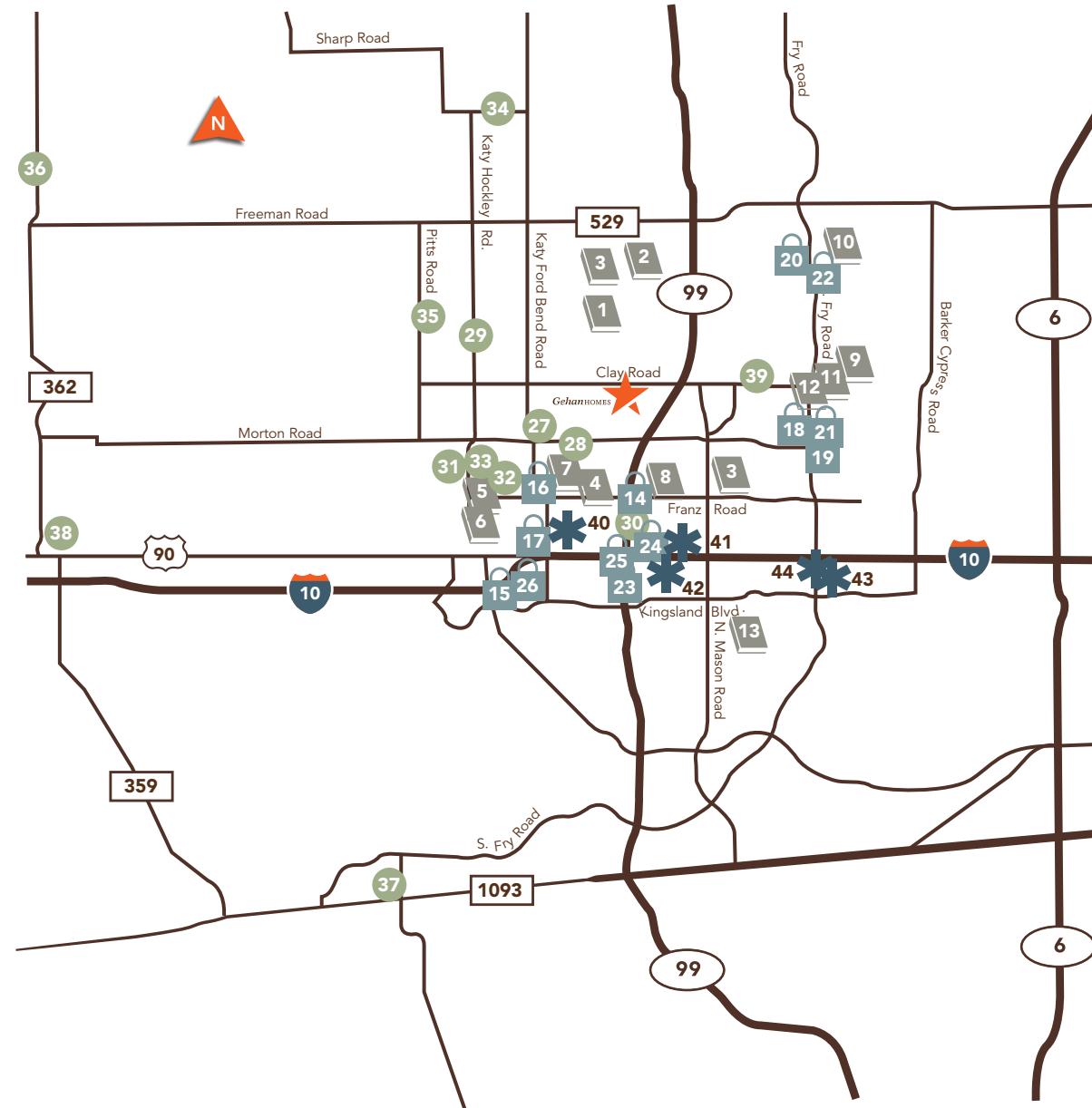

## ★ Katy Trails

### Schools

- 1 | Catherine Bethke Elementary
- 2 | Stockdick Junior High
- 3 | Patricia E. Paetow High School
- 4 | Kids R Kids
- 5 | Katy Adventist Christian School
- 6 | Little People's School
- 7 | Faith West Academy
- 8 | Roots of Learning
- 9 | Katy Kindercare
- 10 | Scholastic Bridge
- 11 | Children's Lighthouse
- 12 | Little Giant's Child Care Learning Center
- 13 | Primrose School

### Shopping

- 14 | JCPenney
- 15 | Katy Mills
- 16 | Walgreens
- 17 | Walmart
- 18 | CVS
- 19 | Randalls
- 20 | Kroger
- 21 | Walmart
- 22 | Aldi
- 23 | Houston Garden Supply
- 24 | Academy
- 25 | Charming Charlie
- 26 | Bass Pro Shops

### Recreation

- 27 | Katy Park
- 28 | Mason Creek Park
- 29 | Four Seasons Park
- 30 | Cinemark
- 31 | Bass Fish Fayette Company
- 32 | City of Katy Dog Park
- 33 | Mary Jo Peckham Park
- 34 | Paul D Rushing Park
- 35 | Gulf Coast Kartway
- 36 | Dewberry Farms
- 37 | Boys & Girls Club - Greater Houston
- 38 | Gold's Gym
- 39 | Riding High Stable

### Hospitals/Clinics

- 40 | Memorial Hermann - Katy
- 41 | Katy Emergency Center
- 42 | Women's Hospital of Texas
- 43 | Houston Methodist - St. Catherine Hospital
- 44 | Texas Children's Hospital

© 2016 Gehan Homes. All rights reserved. Association Fees, Schools and Taxes are estimates only and are subject to change. See local taxing authorities and ISD for most current information. All items shown are an artist's rendering regarding planned community designs and amenities and are subject to change without notice. Katy Trails 05.04.17\*

# Gehan HOMES

## Katy Trails Classic Series



281.574.4623 | 23310 N. Briarlilly Park Circle | Katy, TX 77493



gehanhomes.com

